

SITE PLAN OF PREMISES NO.- 103/2A, RAJ SEKHAR BOSE SARANI.
KOL- 700 025, WARD- 72, BOROUGH-VIII, P.S - BHAWANIPUR.

LAND AREA (AS/ DEED) = 437.105 SQ.M (6K- 8CH-25 SQ.FT)
LAND AREA (AS/ PHYSICAL MEASUREMENT) = 437.084 SQ.M

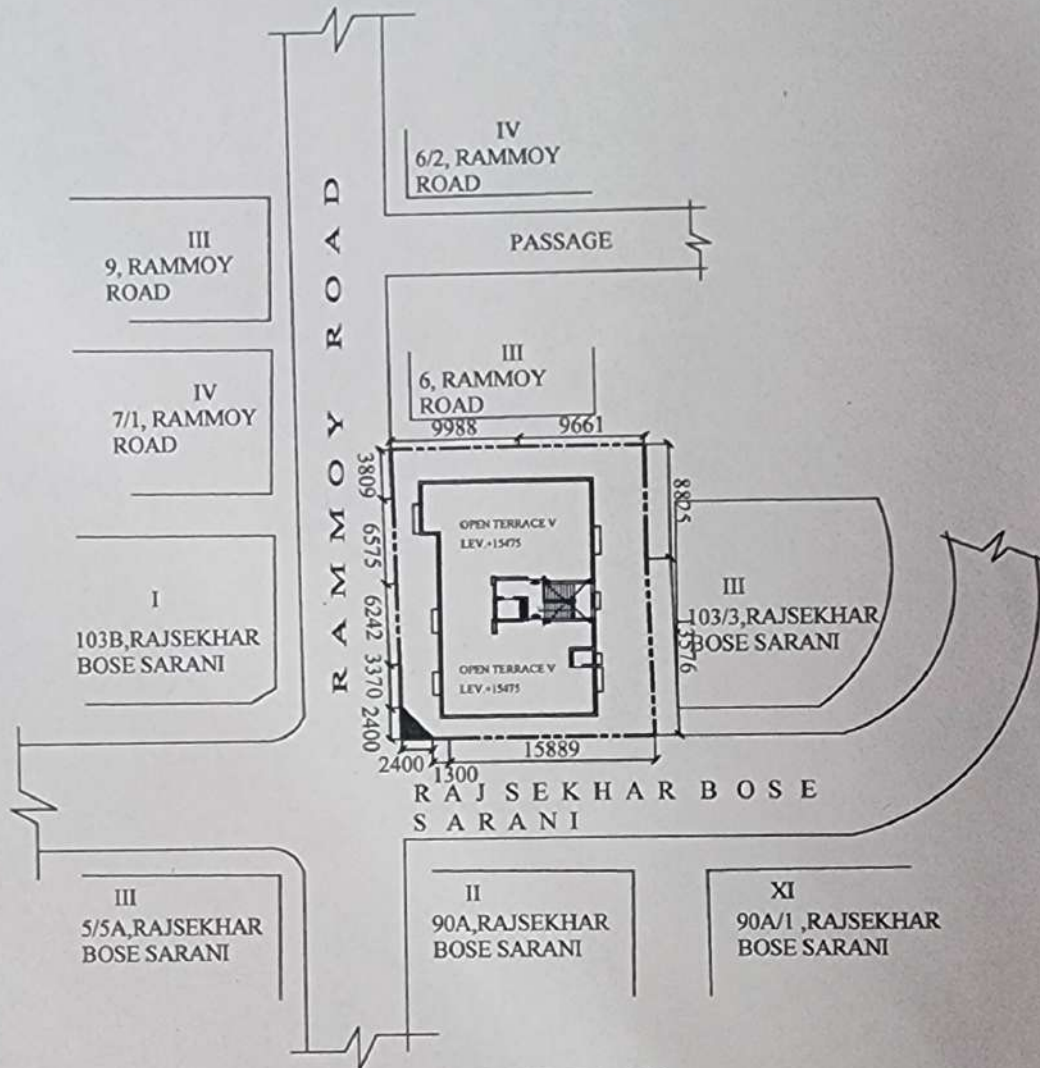

SITE PLAN
SCALE-1:600

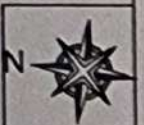

Anjan Ukil
ANJAN UKIL
Architect
C.O.A. Regn. No.- CA/94/16721
L.B.A. A-271

SIGNATURE OF ARCHITECT

Jinanku Deb

SIGNATURE OF OWNER